



VariVIT® wall-mounted installation

Areas of application and product information





VariVIT® wall-mounted installation

One systeme – versatile options

The system offers a whole host of sanitary installation opportunities by using only three connecting elements and the VariVIT construction profile. When combined with user friendly assembly elements such as the Air-WC, it can fulfil any customer requirement which may arise in either the public or private domain.

This provides optimum installation conditions for fitters, whereas specialist wholesalers can enjoy the benefits of a manageable product range which can be combined in a diverse number of ways.

Advantages for fitters

- Flexible and easy to assemble
- Self-supporting and stable
- User friendly mounting elements such as the Air-WC, Lift-WC, Corner-WC
- Construction profile + 3 connecting elements = limitless possibilities
- Easy and rapid cladding using plasterboards or gypsum fibre boards

Advantages for specialist wholesalers

- One basic element covers all kinds of assembly
- Small storage space required
- Easy and rapid resale – high profitability
- Clear and manageable system
- Materials can be quickly and easily put together

FEATURES

Flexible Heights

VariVIT can cope with any situation in public and semi-public environments or in the private domain. A variety of available heights ranging from 85 cm to ceiling-height construction enables the flexible implementation of the most diverse of requirements.



VariVIT wall-mounted installation ...

... at a system construction height of 85 cm.

Ideal for childcare centres, nursery schools, primary schools or for particularly small bathrooms and guest toilets.

... at a system construction height of 100 cm.

Perfect for small bathrooms and guest toilets. Ideal for childcare centres, nursery schools, primary schools.

... at a system construction height of 120 cm.

This is the standard height, tried and tested and applicable for major projects and family homes alike. The 120 cm system construction height can be used in bathrooms, guest toilets and public sanitary facilities of any kind and imposes no restrictions in terms of bathroom design.

... ceiling-height or individual design.

Three connecting components and the VariVIT construction profile enable ceiling-height installations to be implemented precisely and quickly. This system is highly flexible and can be adapted to fit any room or sloping roof.

Perfection down to the last detail

Mounting accessory S



Mounting accessory E



Cistern A31 or B31*

Mounting holes for the metal frame stud wall



This element has been pre-drilled for the connection of toilets with a bidet function



Rotatable floor plate for flexible floor fitting and stability when using UW 50 and UW 75 metal frame stud wall sections



Level marker

Self-supporting and stable assembly frame

Soundproofed** in accordance with DIN 4109 and VDI 4100

Stable connecting cross-sections

Improved outlet bend holder for better installation even where space is at a premium

Height adjustable from 0 to 240 mm



* For low installation heights

** The noise protection quality of individually mounted MEPA cisterns A31 and B31 was tested using the noise protection set (Article No. 548012)

FEATURES

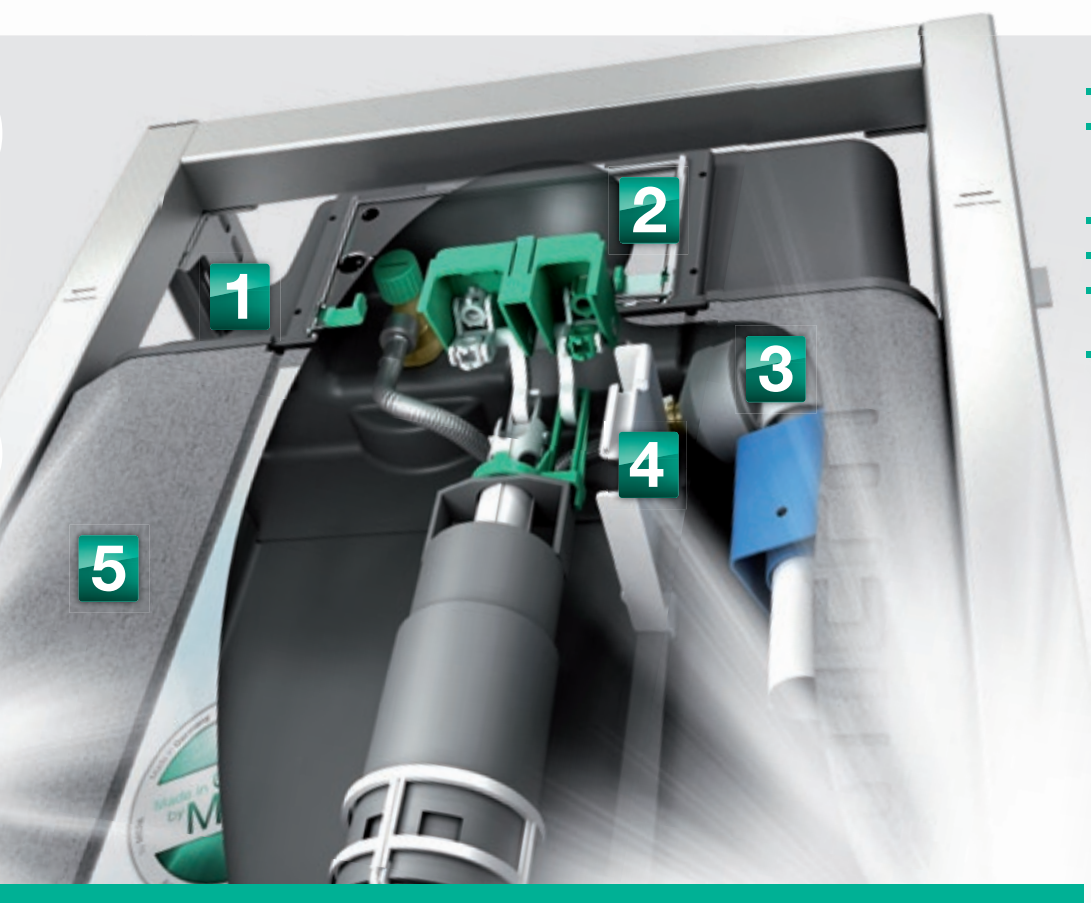

- Side or rear connections **1**
- Inspection hatch which can be opened without the use of tools **2**
- Filler valve **3**
- Filling mark **4**
- Ready for the connection of toilets with bidet function **5**
- Powerful flush function

FEATURES

Sanicontrol A31/B31

A perfectly engineered cistern



Flush volume may be increased to 7.5/4 litres via a simple adjustment to the flush valve. This counters the blockages which may occur with difficult wash pipes.



This reliable filler valve is included in all cisterns. Its inner workings have been standardised to ensure particularly efficient supply of spare parts. The filler valve may also be replaced by a conventional filler valve.



Despite the elegant and small-sized flush plates, easy accessibility to components ensures that the unit is easy to service.



Tests carried out by the Fraunhofer Institute for Building Physics in accordance with DIN 4109 and VDI 4100 confirm the noise protection quality of the MEPA A31 and B31 cisterns.

Holding all the trumps

WC frames



WC frame for construction height 85 cm.

This is an area where the front and top operated B31 cistern really comes into its own. Fully factory pre-assembled and tested ready for installation. Ideal for childcare centres, nursery schools, primary schools or for particularly small bathrooms and guest toilets.



WC frame for system construction height 100 cm.

Perfect for small bathrooms and guest toilets. Ideal for childcare centres, nursery schools and primary schools. Another area where the B31 cistern can show what it can do. Fully factory pre-assembled and tested ready for installation.



WC height 85

- With B31 concealed cistern
- Pre-assembled mounting frame
- Includes accessory for individual mounting
- Ready for the connection of a toilet with bidet function

(MEPASun not suitable for top-operated mechanisms)

WC height 100

- With B31 concealed cistern
- Pre-assembled mounting frame
- Includes accessory for individual mounting
- Ready for the connection of a toilet with bidet function

(MEPASun not suitable for top-operated mechanisms)



The tried and tested standard – system construction height 120 cm.

The A31 concealed cistern set in the VariViT frame at conventional wall-mounted height. Fully factory pre-assembled and tested ready for installation.



A space-saving solution for guest toilets and bathrooms.

A corner assembly frame enables rooms to be restructured. In small bathrooms in particular, WC's sometimes need to be placed on the diagonal.



WC height 120

- With A31 concealed cistern
- Pre-assembled mounting frame
- Includes accessory for individual mounting
- Ready for the connection of a toilet with bidet function
- Factory punched gypsum fibreboards available for all connections

Corner-WC

- Ideal for small bathrooms where the emphasis is on high quality of design
- Wall-mounted installation frame for WC with integrated E31 concealed cistern
- Includes pre-punched gypsum fibreboards for front and top panelling

Urinal frames



Universal frame for concealed urinal flushing systems.

One frame – wide-ranging functionality. This urinal frame can be used with the MEPA infrared controls Sanicontrol 925 and 825. It can also be combined with the mechanical MEPAzero and MEPAorbit concealed flushing valves. Providing the greatest degree of flexibility for projects of every size and requirement.



Urinal frame for Sanicontrol K3.

The urinal frame for the electronic control system Sanicontrol K3 comes equipped with intelligent technology. There are no elements above the urinal which could strike the wrong aesthetic note or come into contact with the cover of the urinal. The flush actuation sensor is safely hidden away in a vandal-proof area in the siphon.

Urinal frame Part 1

- Continuously height adjustable connecting cross-sections
- Fits MEPA urinal automatic flush systems 925/825
- Suitable for the MEPAzero/MEPAorbit concealed flushing valve
- Fits a wide range of urinals manufactured by Duravit, Ideal-Standard, Keramag, Laufen, Roca, Sphinx, Villeroy & Boch and Vitra*

Urinal frame K3

- Continuously height adjustable connecting cross-sections
- Reliable, long-life siphon sensor control
- Ideal for private use as well as for public areas
- Vandal-proof
- Fits a wide range of urinals manufactured by Duravit, Ideal-Standard, Keramag, Laufen, Roca, Sphinx, Villeroy & Boch and Vitra*



Urinal frame for exposed flushing valve.

A fully flexible mounting frame can be equipped with all conventional exposed urinal flush valves. Provides the maximum degree of flexibility for projects of any size.

Urinal frame for exposed flushing valve

- Suitable for all conventional exposed flushing valves, both mechanical and electronic
- Perfect for combining with the Sanicontrol T606 exposed automatic urinal flushing system

- Continuously height adjustable connecting cross-sections
- Fits a wide range of urinals manufactured by Duravit, Ideal-Standard, Keramag, Laufen, Roca, Sphinx, Villeroy & Boch und Vitra*

The right solution for any requirement

More frames



Washstand frame single lever mixer.

Covers virtually all washstand solutions. This element can also easily be shortened to make it suitable for use with system construction heights of 85 cm and 100 cm.



Bidet frame.

Suitable for almost all commercially available bidets. The height of the element can be reduced to 85 cm with corresponding accessories, if the elements are to be installed underneath a window or a roof pitch.

Washstand frame single lever mixer

- Wall-mounted installation frame for washstand single lever mixer
- Can be shortened for system construction heights 85/100 cm
- Includes accessory for individual mounting
- Continuously height adjustable connecting cross-sections

Bidet frame

- Wall-mounted installation frame
- Can be shortened for system construction heights 85/100 cm
- Includes accessory for individual mounting

VariVIT construction profile

One basic element for all kinds of assembly

The construction profile lies at the very heart of the VariVIT system. Flexible connections may be made to three of its sides, whilst the fourth flat side enables easy cladding. The system uses a few connecting components to offer a rapid and simple form of assembly and opens up a whole host of new opportunities, particularly in the field of individual bathroom design.



Mounting techniques

Individual mounting

Provides a perfect installation against any solid wall. Individual mounting is the simplest form of installation and offers a particular range of benefits for any kind of project, especially when time is pressing.



If installation takes place on an unfinished floor surface, the adjustable feet may be extended out according to screed level (maximum 240 mm). The use of an extension accessory enables heights of up to 480 mm to be achieved!

The base plate may be rotated in 90° stages. This provides perfect conditions for a comfortable working position and rapid assembly, even when space is tight.



- All mounting elements may be installed using individual mounting
- Mounting Accessory E is supplied as standard with all systems which are frequently required, such as WC's and washstands
- High degree of pre-fabrication means that assembly can take place in minutes
- Ideally supplemented with stud wall systems, of particular benefit for major projects
- An open system which ensures the maximum degree of flexibility for the installation of all supply and waste pipes

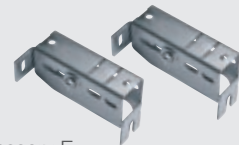

Accessory E for installation against a solid wall.

Rail mounting

Our rail system makes it child's play for wall-mounted installation to be carried out by one person. Rail mounting is quick, simple and uncomplicated and can take place against a solid or metal frame stud wall. Accessories are also available for ceiling-height or individually designed constructions.



Accessory S



Corner and universal connector

Metal frame stud wall

The use of metal frame stud walls is standard modern practice, particularly for new builds or renovation projects. None of this is any problem for the VariVIT mounting systems, which can be integrated into any stud wall design.



Accessory L



Design is an absolute must!

WC flush plates

With the flush plates MEPAzero, MEPAorbit and MEPAsun you find a full range of high-end products following all demands of time. The plates are made of high-quality, durable and lightfast materials of plastic and glass surfaces. As well for special requirements of durability and security manufactured in stainless steel.

Partly embedded only 4 mm above the tile panel, the MEPAzero and MEPAorbit strikes an elegant note in anyone of its glass models (white, silver, black) or in stainless steel.



overlying



partly embedded



plate embedded

MEPAzero

With its range of surface designs of plastic and glass MEPAzero gives space for creation design in your bathroom. The MEPAzero made of stainless steel is with its surface timeless and a precious appearance.

Fitting to the toilet flushing plates MEPA now also offers urinal plates in the same design.



- Dual flush technology
- Available in 9 different surface designs
- Installation: plate embedded, partly embedded or overlying
- Compatible with Sanicontrol 1061 or 1065 WC automatic flush system



MEPAorbit

The MEPAorbit features puristic and clear lines and offers a high level of design freedom. Made of glass or stainless steel, it exerts a tangible presence whilst still retaining an impressive lightness. Additional to the design surfaces we give the opportunity to change the design of the plate. Now you can choose other stylish buttons of the plates. The materials of the design-buttons are available in glass and stainless steel. MEPAorbit now also is available for urinal frames.



- Choice of single/dual flush technology
- Available in 9 different surface designs
- Exchangeable design-buttons
- Installation: plate embedded, partly embedded or overlying
- Compatible with Sanicontrol 1061 or 1065 WC automatic flush system



MEPAstainless Steel

A vandal-proof actuation which provides a stylish and elegant look for sanitary facilities, particularly in commercial properties.



- Choice of start/stop function or single/dual flush technology
- Available in 5 different surface designs
- Compatible with Sanicontrol 1061 or 1065 WC automatic flush system



MEPAsun

The MEPAsun features a modern design and offers both a high degree of functionality and a long product life. The flowing lines and gentle division of this attractively shaped actuation plate enables a choice to be made between a start/stop function or single/dual flush technology.



- Choice of single/dual flush technology
- Vandal-proof stainless steel surface
- Compatible with Sanicontrol 1061 or 1065 WC automatic flush system

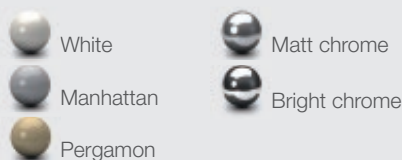

Do you require more ...

... information?

Request MEPA's comprehensive and professional product information brochures on the topics of bath tub installation technology, floor-level showers, wallmounted installation, cisterns and flushing systems.

Visit us online at „www.mepa.de“ for 24/7 information on a whole host of products. Information may also be downloaded to provide you with all the practical assistance you require.



www.mepa.de

Any questions?

Contact us by e-mail. We will get back to you straightaway.
produktservice@mepa.de.

Blue Responsibility
Sustainable Sanitary Solutions

For more information on
"Blue Responsibility", please visit
www.blue-responsibility.com



MEPA – Pauli und Menden GmbH

Headquarters and sales

Rolandsecker Weg 37 | D-53619 Rheinbreitbach
Tel. +49 (0) 22 24 / 9 29 - 0 | Fax +49 (0) 22 24 / 9 29 - 1 49
www.mepa.de | info@mepa.de

Austria sales

Lemböckgasse 47 | A-1230 Vienna
Tel. +43 (0) 1 / 8 14 15 - 0 | Fax +43 (0) 1 / 8 14 15 - 16
www.mepa.at | info@mepa.at